

BACK DOOR

COMPONENTS (Lift Up Type)

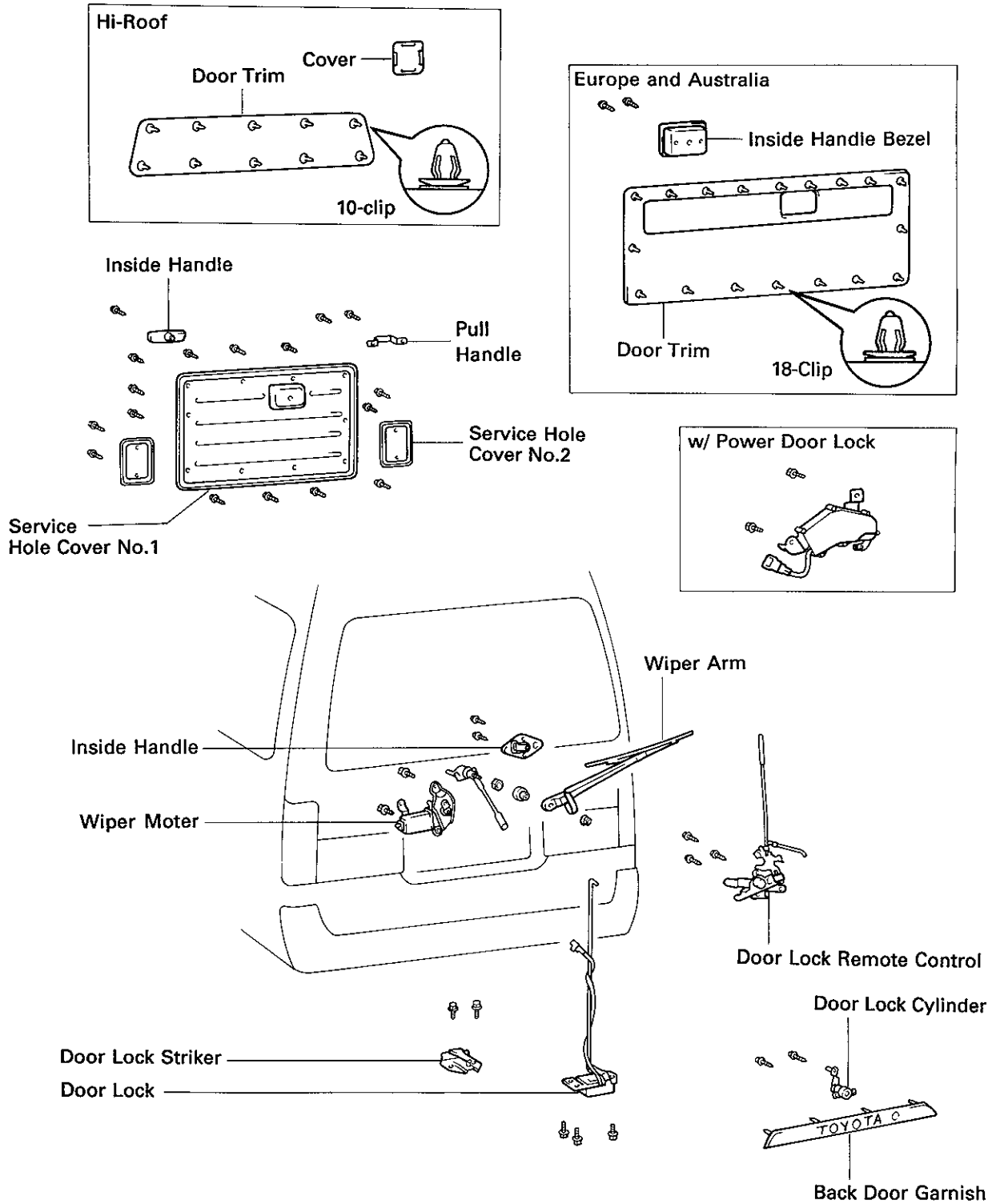

COMPONENTS (Swing Out Type)

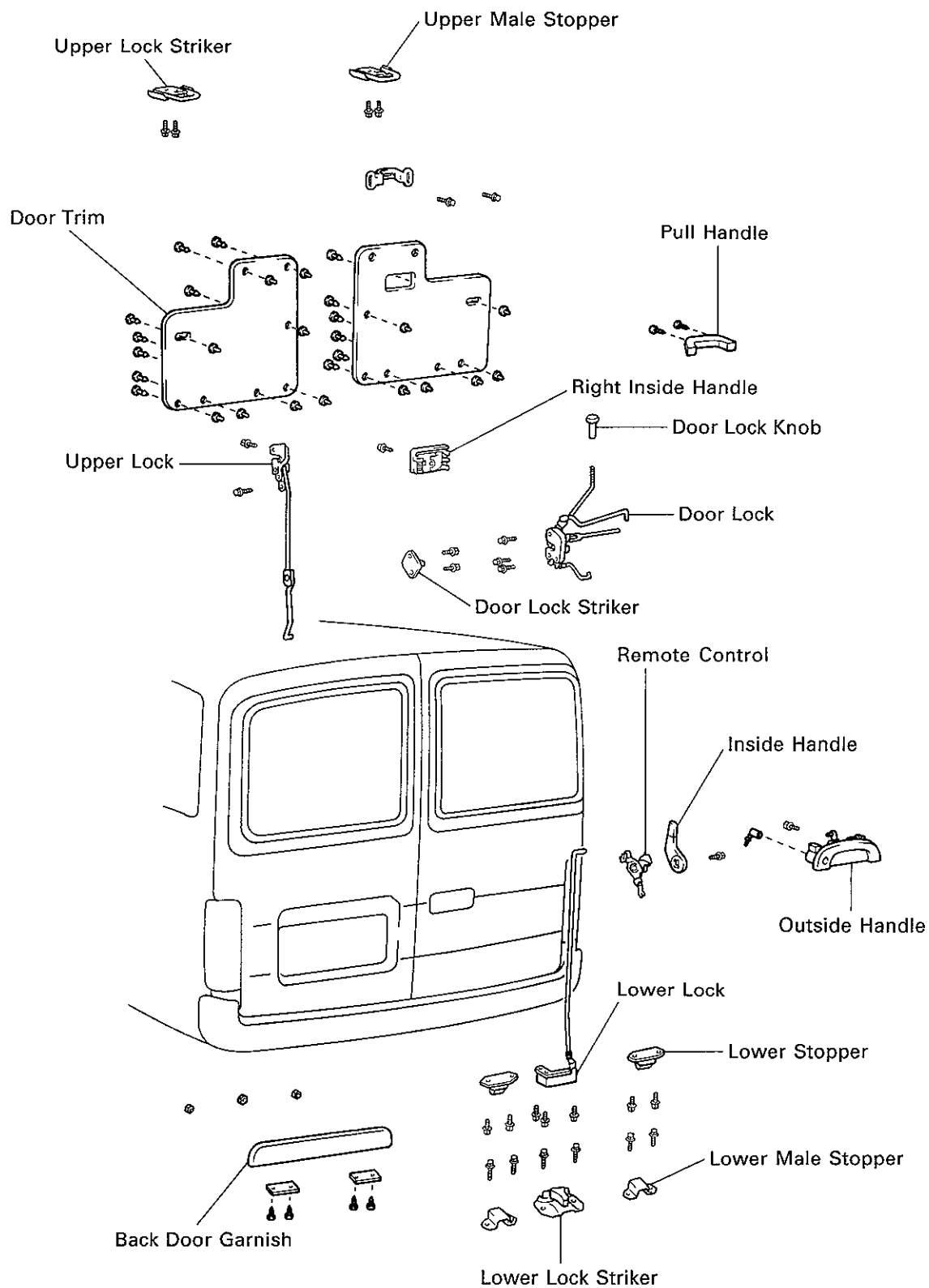

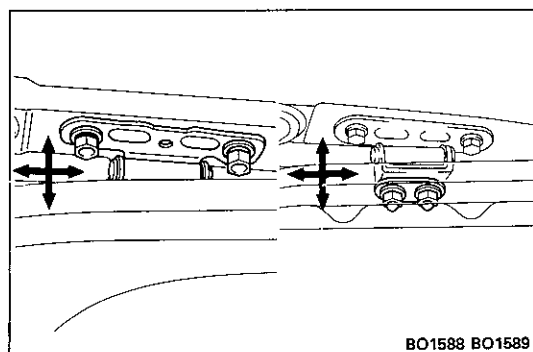

ADJUSTMENT OF BACK DOOR (Lift Up Type)

1. ADJUST BACK DOOR IN FORWARD/REARWARD AND LEFT/RIGHT DIRECTIONS

Adjust the door by loosening the hinge bolts.

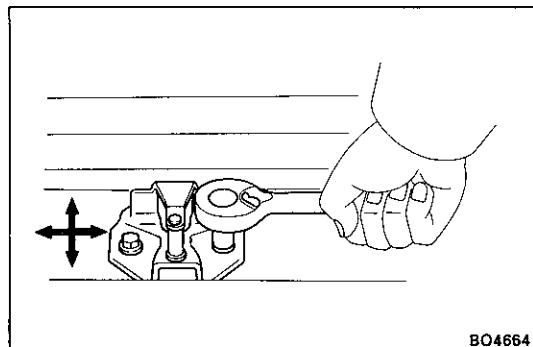

2. ADJUST DOOR LOCK STRIKER

- (a) Loosen the mounting bolts to adjust the lock striker.
- (b) Using a plastic hammer, tap the striker to adjust it.

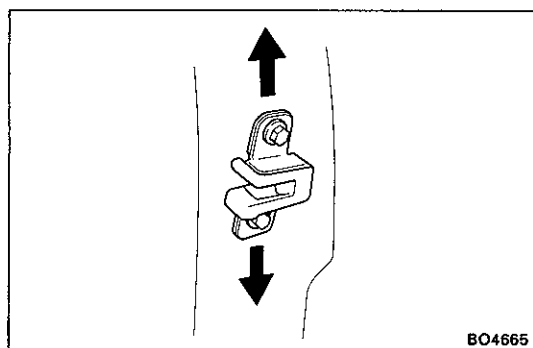

3. ADJUST BACK DOOR STOPPER

Loosen the mounting bolts to adjust the stopper.

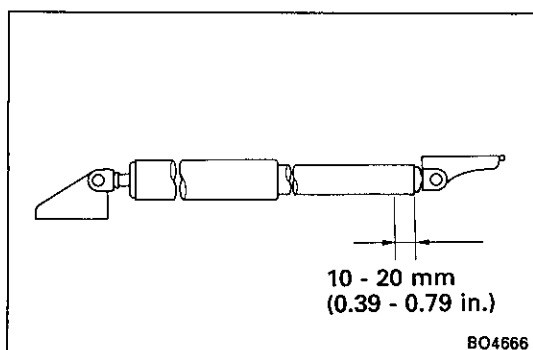

BACK DOOR DAMPER STAY

NOTICE: Handling the damper.

- (a) Do not disassemble the damper because the cylinder is filled with pressurized gas.
- (b) If the damper is to be replaced, drill a 2.0 – 3.0 mm (0.079 – 0.118 in.) hole in the bottom of the removed damper cylinder to completely release the high-pressure gas before disposing of it.
- (c) When drilling, chips may fly out so work carefully.
- (d) The gas is colorless, odorless and non-toxic.
- (e) When working, handle the damper carefully. Never score or scratch the exposed part of the piston and rod, and never allow paint or oil to get on it.
- (f) Do not turn the piston rod and cylinder with the damper fully extended.

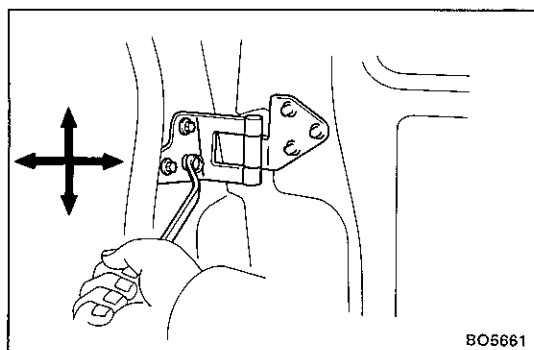

ADJUSTMENT OF BACK DOOR (Swing Out Type)

1. ADJUST BACK DOOR IN LEFT/RIGHT AND VERTICAL DIRECTIONS

Adjust the door by loosening the body side hinge bolts.

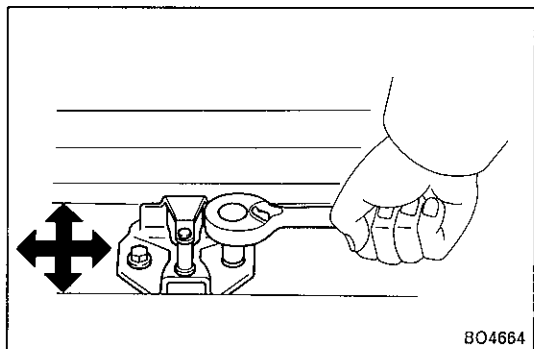

2. ADJUST LOWER LOCK STRIKER

- (a) Loosen the mounting bolts to adjust the lock striker.
- (b) Using a plastic hammer, tap the striker to adjust it.

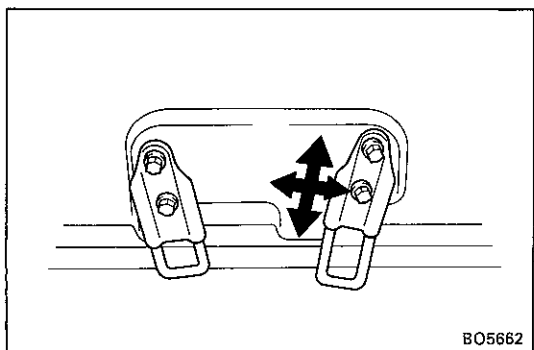

3. ADJUST UPPER LOCK STRIKER

- (a) Loosen the mounting bolts to adjust the lock striker.
- (b) Using a plastic hammer, tap the striker to adjust it.

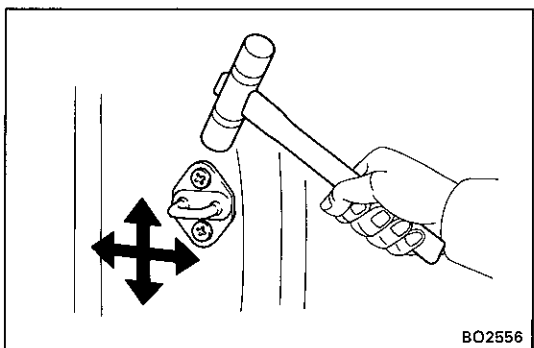

4. ADJUST DOOR LOCK STRIKER

- (a) Loosen the mounting screws to adjust the lock striker.
- (b) Using a plastic hammer, tap the striker to adjust it.